

Government of Jammu and Kashmir
Ladakh Autonomous Hill development Council Kargil
OFFICE OF THE MEMBER SECRETARY IMC GOVT. ITI KARGIL

TENDER FORM (ITI)

1. Tender form No:- _____
2. CDR No _____
3. Amount of CDR _____

Dated: _____

S.No	Name of Items	Speci ficati on	Rate offered	
			In figure	In words
1	CAD software (10 user licensed latest version			
2	Plotter A1 size HP Design Jet range, Canon image PROGRAF, Epson Stylus PRO, ox and Oce			
3	Digital Theoldolite latest model with all accessories (Featured:- Based on laser technology, two large LCD panel with easy to read, Automatically compensates title in two direction and compensates vertical angles. High integrated electronic board and IC elements) (Detailed specification in annexure)			
4	Instrument for Total station with latest model, with all accessories (graphic LCD display on both side, multi function keyboard on bot side,. Able to intercahange data between GPS and totalstation without any data conversion minimum 8 hours rechargeable li-ion batter. Poles and prism 2 /nos each 0 (Detailed specification in annexure)			
5	Hand held GPS 9latest mode) with standard specification(Detailed Specification in annexure)			
6	Auto level with all accessories)			
7	Computer Tables (Detailed specification in annexure)			
8	Computer chairs (specification in annexure)			
9	Box drawing instrument containing one 15cm compass with pain, pin point and lengthening bar, one pair spring bows, rotating compass with interchangeable ink and pencil point, drawing pens with plain point and cross poin, screw drover and box f leads. (0.2.0.3.4mm)			
10	Projector celluloid 15 cm semi circular.			
11	Scale card board-metric set of eight A to H in a Box 1:1, 1:2, 1:2.5 ,1:5,1:10,1:20,1:50 1:100, 1:200, 1:500, 1:1000, 1:2000, 1:1250, 1:6000, 1:38 1/3, 1:66			
12	Scale plotting box wood 6 metric scales 30 cm long with offset			
13	Set square transparent 20cm, 2mm thick with beveled edges 45			

	degree.			
14	Set square transparent 20cm, 2mm thick with beveled edges 60			
15	T-Square 1250mm/mini drafter/parallel Bar			
16	Template-Architeets and builders			
17	Geometrical models (wooden/plastic) as given below			
A	Cube 08cm dia			
B	Rectangular parallel piped 8cmx15cm			
C	Sphere 8cm dia			
D	Right circular cone 8cm dia base and 15 cm vertical height			
E	Square pyramid 8cm side base and 15cm vertical height			
F	Cylinder 8cm dia, 15cm height.			
G	Prism triangular 8cm side triangle and 15 length			
H	Prism hexagonal 8cm sides hexagonal and 15 length			
19	Templates circle, Ellipse, furniture, etc			
20	Flexible curve 80cm long			
21	Radius curve Matric 3mm to 15 mm			
22	Brass parallel rulers in a case			
23	Calculator scientific (Non-Proramable)			
24	Propotional dividers 15cm			
25	Steel tape 30 meter long.			

We agree to able by all the terms and conditions mentioned in the Tender notice endorsement tender notification No;ITI-K/Tender/PPP/2017-18/32-40 dated:-24-06-2017 issued by Member Secretary Institute Management Committee (IMC) ITI Kargil (all pages which signed by as in token of acceptance mentioned therein.

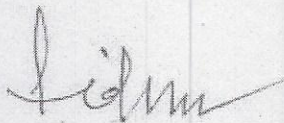

**Member Secretary
Institute Management Committee
IMC,ITI, Kargil**

**Seal and Signature of
Tenderer**

Technical Specification GPS Handheld:

Features	Specifications given below are minimum required
Operating System	Windows Embedded Handheld 6.5 Professional
CPU	800 MHz
GPS Receiver	Integrated high sensitivity GPS receiver and antenna with 50 channels, NMEA support should be available
Display	4" WVGA, Directly seen in the sunlight, It should be with Gorilla glass display
Memory	Handheld device should have a RAM of 512MB and Flash memory of 5GB. The handheld should support 32GB SD Card also.
Camera	5MP Camera with LED flash and geotagging facility available even without using Data collection software
Battery	Battery should be 3300 mAh lithium-ion rechargeable battery with 8 hours working in the field
Connectivity	Handheld device should have Bluetooth, Wi-Fi and USB connectivity
GPS Accuracy	GPS should be able to provide 2-4 meter Real Time Accuracy with SBAS (EGNOS, WAAS, GAGAN, MSAS) and 1-3 meter accuracy in differential correction mode/post processed mode
Time to first fix	30 seconds
MicroSD Card	32GB expandable slot
USB Cable	Should be provided for data transfer
Power cable	YES
IP casing	Handheld casing should be IP 68 standard with 90% humidity limit
Drop	It should be 1.22m
Temperature	Operating Temperature should be in between -30 degree C to +60 degree C and Storage Temperature should be -40 degree C to +70 degree C

Data Collection Software:

Software should allow for Graphical attribute selection, in addition to textual attributes
Conditional-based attributes facility, i.e. attribute values should dynamically adapt to user inputs on data capture forms
Accurately predict the post-processed accuracy while data collection in the field
Configure user-interface & lock the configuration settings to field users
Support for search, sort and filter capabilities to allow quick and accurate feature identification in the field
There is an audio and visual warnings and alarms for loss of GPS position
Provide easy to use zoom in, zoom out, pan, autopan, select, query, measure, search, and filter capabilities for flexible and powerful map display

S/dac

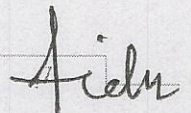

Capability to collect point & line offsets for inaccessible areas
Include time saving features for attribute entry including, default values, menu pick lists, auto-incrementing, and auto generation of date and time attributes
Software should support for GPS logging of points, lines or areas for simple and accurate feature capture
Support for digitizing of points, lines or areas for simple feature capture when GPS is not available
It should allow configuration of navigation information including distance, bearing, heading, velocity, go east, go north, go up, go down, ETA and time to go, cross track error, altitude and turn direction
It should support for waypoint upload and display
GPS coordinates in the Latitude/Longitude (WGS 84) & UTM system

Total Quantity required	2
Warranty required	3 years onsite

Sr-faculty

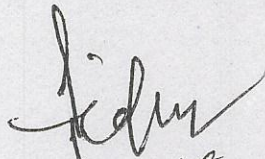
Superintendent
I.T.I Kargil

Detailed specifications**1. Dimensions:**

All dimensions are minimum value.

Nomenclature of dimensions is as per diagram at Annexure-II (Refer annexure-II for dimensions only)

- Seat Height (SH): 430 MM (min.) (without seat lift)
560 MM (min.) (with seat lift)
- Seat Lift: 130 (min.)
- Total chair Height (H): 670 MM (min.)- low position (with seat lift & without back lift)
900 MM (min.)-high position (with seat lift & with back lift)
- Back Lift: 230 MM (min.)
- Wheel Base:
 - Depth (D): 640 MM (min.) (Caster wheel base)
 - Width (W): 640 MM (min.) (Caster wheel base)
- Seat Size:
 - Seat Depth (SD): 420 MM (Min.)
 - Seat Width (SW): 440 MM (min.)
- Back Seat
 - Back Height (BH): 280 MM (min.)
 - Back Width (BW): 380 MM (min.)
- Seat Back Tilt: adjustable 0- 15 degrees

2. The Seat and Back Cushion of the chairs should be pressed on 12 mm hot press moulded ply. The seat cushion of the chair should be with density of $45 \pm 2 \text{ Kg/m}^3$ polyurethane moulded and back cushion with density $33 \pm 2 \text{ Kg/m}^3$. The polyurethane foam shall be as per manufacturer's specification. The hardness of foam shall be $16 \pm 2 \text{ kgf}$ as per IS7888 for 25% compression and it should be covered with blue/brown/cherry fabric.
3. The arms of the chair should be black.
4. The lift mechanism should be pneumatic or hydraulic.
5. 360° revolving type.
6. The pedestal should be five legged with 5 nos. twin wheel castors. The twin wheel castors to confirm as per IS Standards.
7. Guarantee of 1 year is required.
8. All material should be used as per IS Standard.

See/F

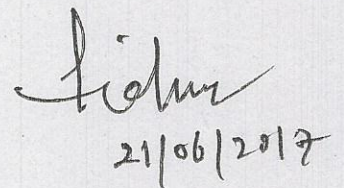



21/06/2017

COMPUTER CHAIR

Annexure-II

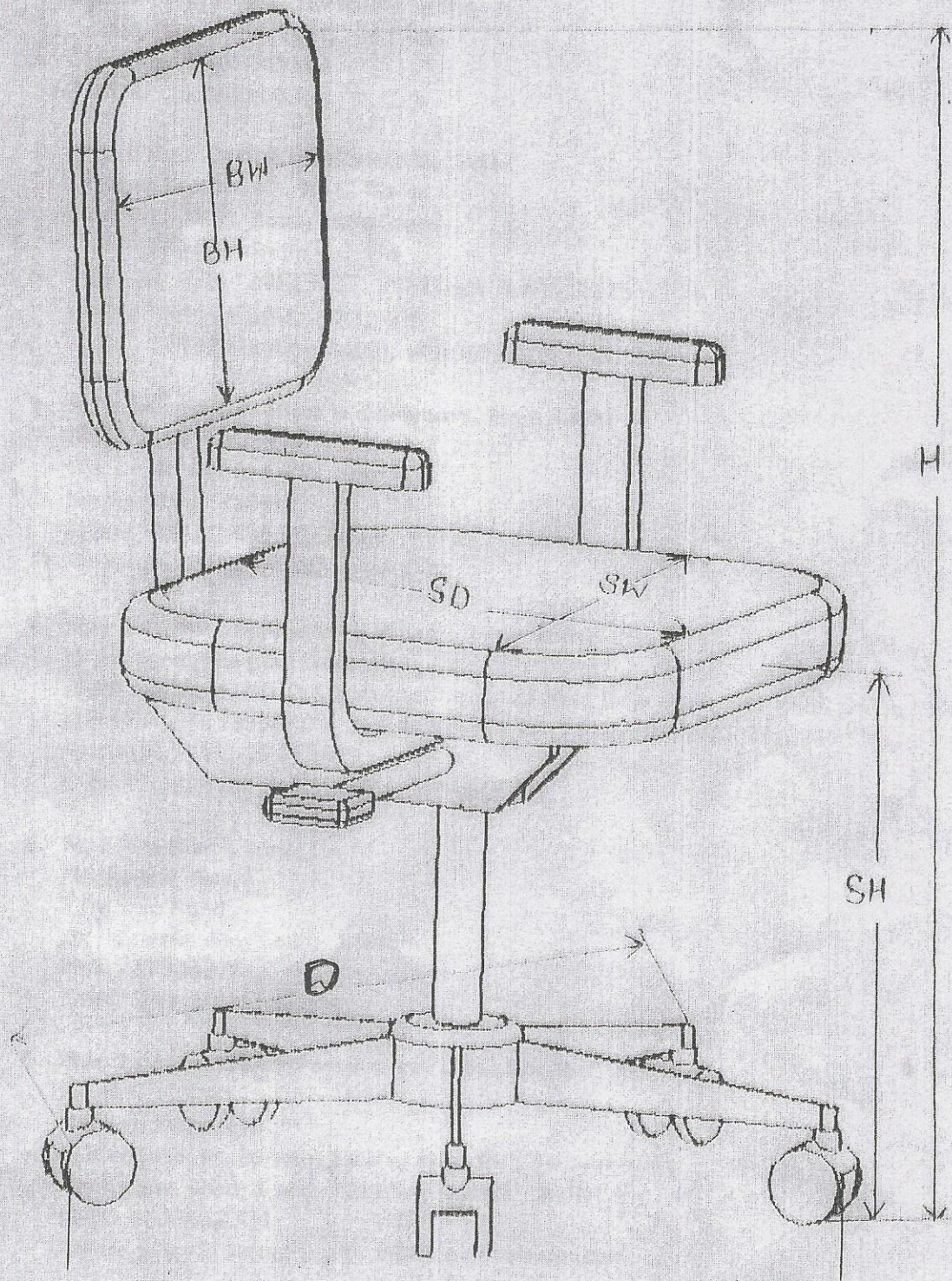
3



Sen/R

[Signature]

and

[Signature]

21/06/2017

Annexure of Computer Table

B = 3.2 ft

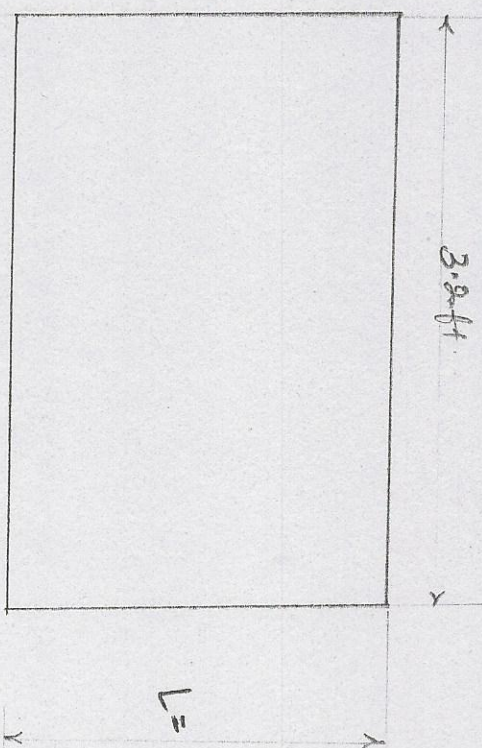

L = 50 cm (2 ft)

Top view

(3.2 ft)
90.7 cm

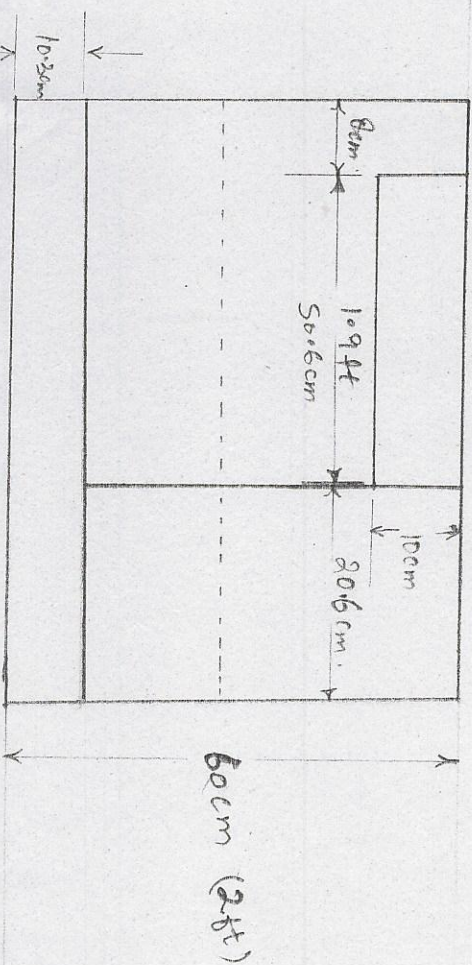

60 cm (2 ft)

90.7 cm

Front view

50 cm (1.7 ft)

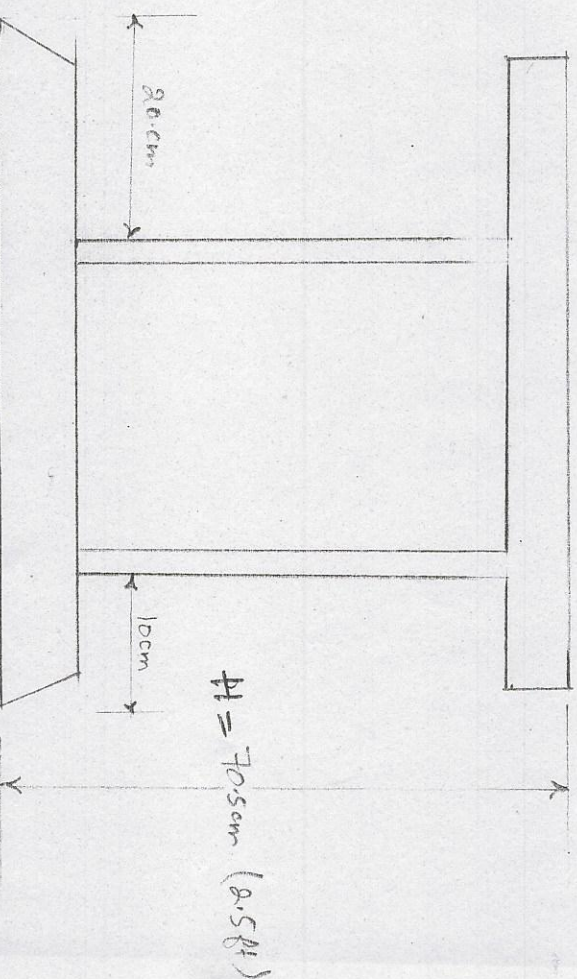

H = 70.5 cm (2.5 ft)

60 cm
2 ft

Side view